

**COMMERCIAL RECYCLING  
EQUIPMENT**



# MOBILE COMPACTOR

**MC14**

## THE BENEFITS

- ✓ Safe & easy to operate
- ✓ Cuts uplifts & transport costs
- ✓ It has a  $\frac{3}{4}$  full & full indicator
- ✓ Liquid retentive
- ✓ Saves space (Up to 6:1 compaction ratio)
- ✓ Odour free, tidier & more efficient site



Visit [www.pearce-group.co.uk](http://www.pearce-group.co.uk)  
or call us on **0800 083 3333**

### Dimensional Data

Overall Width	1777mm
Overall Length	4398mm
Overall Height	2330mm
Machine Weight	2900kg
Machine Capacity	12m <sup>3</sup>

### Electrical Specification

Supply Voltage	415vac
Phase	3ph
Max Current	32A
IP Rating	IP55
Control Circuit	24vdc

### Machine Specification

Compaction Force	27500
Motor	4kw
System Pressure	175 bar
Cycle Time	62 secs
75% Full Light	
100% Full Light	

### Optional Features

SmartTec (status notifications)
SolarPac (solar power)



Having the Pearce compactors on site has greatly reduced our waste bill; they have also enabled us to sort our recycling more efficiently... During our 10+ year relationship with Pearce Compaction we have found all areas of the business from the office to the service engineers to have a professional and positive attitude towards our custom.

**Trevor Fears**  
Amsafe

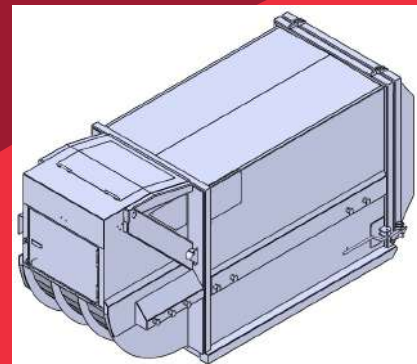

## GET IN TOUCH



**Pearce Group Head Office**  
Pearce House, Acrewood Way,  
St Albans, Hertfordshire, AL4 0JY

Email: [compaction@pearce-recycling.co.uk](mailto:compaction@pearce-recycling.co.uk)  
Web: [www.pearce-group.co.uk](http://www.pearce-group.co.uk)  
Call: **0800 083 3333**

