

COMMERCIAL RECYCLING EQUIPMENT



CAN PRESS

CP30

THE BENEFITS

- ✓ Safe and easy to operate
- ✓ Saves space (Avg. 8:1 compaction ratio)
- ✓ Fewer collections required
- ✓ Complies to BS EN 16500:2014
- ✓ Uses minimal floor space
- ✓ Considerable financial savings
- ✓ Environmentally friendly
- ✓ Crushes cans and tins up to 25 litres



Visit www.pearce-group.co.uk
or call us on 0800 083 3333

Dimensional Data

Overall Width	880mm
Overall Depth	795mm
Overall Height	2506mm
Back Wall Clearance	500mm
Side Wall Clearance	500mm
Can Capacity	25 litre
Machine Weight	250kg

Electrical Specification

Supply Voltage	230vac
Phase	1ph
Max Current	13A
IP Rating	IP55
Control Circuit	24vdc

Machine Specification

Compaction Ratio	Avg. 8:1
Compaction Force	30kN
Motor	1.1kw
System Pressure	85 bar
Cycle Time	27 secs
Pump	7 lpm



This Can Press helps our company a lot by saving space in our scrap metal bin, therefore we can get more weight in each bin meaning we get bigger rebates.

We would certainly use Pearce Compaction Systems again if we needed any more equipment.

Pearce Compaction Systems
customer

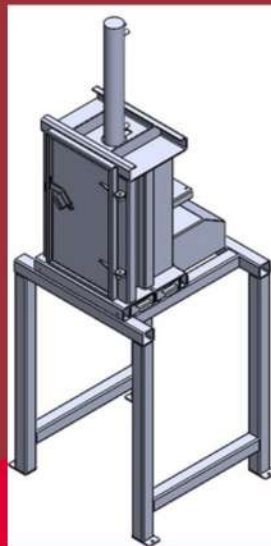

GET IN TOUCH



Pearce Group Head Office
Pearce House, Acrewood Way,
St Albans, Hertfordshire, AL4 0JY

Email: compaction@pearce-recycling.co.uk
Web: www.pearce-group.co.uk
Call: 0800 083 3333

